

## WAY LED STEP LIGHT

The WAY step lights combine durability with a sleek and modern appearance. Designed to create an inviting atmosphere by enhancing the aesthetics of a space and accentuating architectural features as well as key focal points, these luminaires will also efficiently illuminate staircases and passageways.

66  
wet  
location



### ■ Versatile Series

With a sleek design, the WAY series is ideal for multiple usage ranging from highlighting focal points to facilitating movement in the dark. This series provides a vast number of possibilities, whether it be horizontal or vertical mounting, with or without sensor, its versatility is perfect to be integrated in a variety of applications.

### ■ Ideal for Exterior Use

Complete with IP65 rating (wet location), this product is suitable for both indoor and outdoor applications. WAY step lights will not only improve visibility through efficient illumination, but also create an ambiance to the chosen setting in highlighting key features.

### ■ Sensor Option Available

Save on energy costs while still enjoying a well-lit passageway. The WAY step lights can intelligently respond to both motion and light conditions, hence conveniently turning the luminaires ON or OFF automatically when necessary and making it easier to get around in the dark.

## Light the WAY

### Slim Profile

The face plate blends perfectly into the application without protruding from the wall. No visible hardware or remote driver required.

**5** thickness mm

- 2" x 4" deep electrical junction box is recommended.



Scan for more details

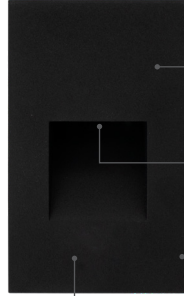

- Durable die-cast aluminum housing
- 90+ CRI for true color accuracy
- Available in white and black finish
- Available in both horizontal and vertical



## PIR Motion Sensor & Photocell

No manual operation required.

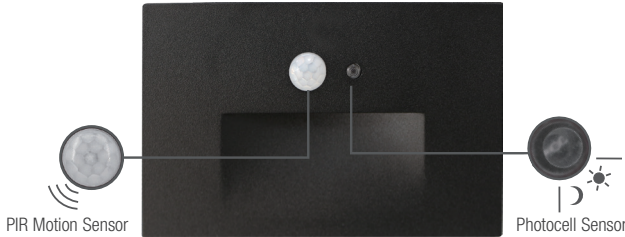

During the daytime, the light will not turn ON as it is too bright to trigger the photocell.



During the nighttime, if motion is not detected, the light will not turn ON.



If motion is detected, the light will remain OFF.



If motion is detected, the light will automatically turn ON. (1 min. hold time)

## Easy Installation

Just 3 steps!

### Step light without sensor

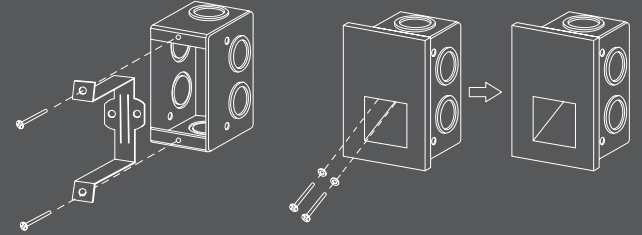

1. Install mounting bracket.
2. Make wire connections.
3. Mount luminaire with 2 screws.

### Step light with sensor

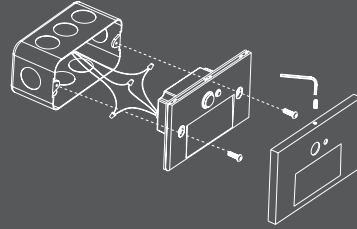

1. Remove the face plate from the housing.
2. Make wire connections.
3. Mount housing on junction box, and install face plate.



### Outdoor installation

To ensure installation is properly sealed, caulking is required along with the use of waterproof junction box.

## Recommended Spacing

