

## PTR LED ROUND POST TOP

The PTR round LED post top luminaire offers a contemporary and elegant look making it a great addition to applications where energy efficiency, performance and design is essential. In 3 easy steps, the mounting arm can be interchanged with either a slipfitter or a square/round pole arm, fulfilling the need for a variety of projects. Typical applications include urban streets, walkways, parks, shopping malls, residential areas, and campuses.

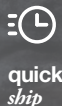

quick  
ship



### ■ Color and Power Selectable

This post top solution is offering ultimate versatility, with the ability to change the color temperature (3 000/4 000/5 000 K) and lumen output to meet the needs of a variety of projects and applications. An ideal solution for reducing stocking inventory.

### ■ 7 pin Receptacle and Shorting Cap

Adjust the intensity of your light to better suit your application.

### ■ Mounting Options

Comes with an elegant arm that accommodates 2-3/8"-3" tenons and can easily be interchanged with a slipfitter or a square/round pole arm, both arms are sold separately.



# FEATURES



# VERSATILE

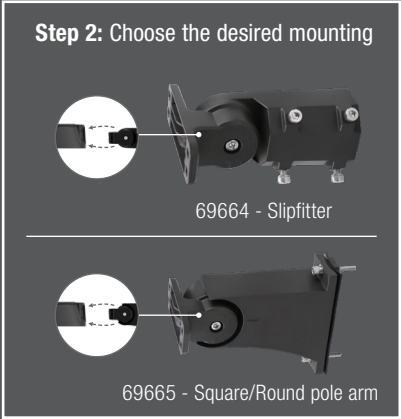

<sup>1</sup> Refer to the installation instruction for more details

# Summary Specification Table

Order code	Model number	Watts	Volts	Color temp.	Lumen output	Efficacy	CRI	Life L70	Distribution type	B.U.G.	EPA	Finish	Dimming	PF	THD	Master case qty
		(W)	(VAC)	(K) <sup>1</sup>	(lm) <sup>2,3</sup>	(lm/W)		(hrs) <sup>4</sup>			(ft²)		(Yes/No)		(%)	
69662	PTRPS755Q3CBKPR7	50/60/75	120-347	30/40/50K	6 750/8 100/ 10 125	135	80+	50 000	Type V	B3-U0-G3	1.48	Black	Yes	0.90	20	1
69663	PTRPS1505Q2CBKPR7	100/120/150	120-347	40/50K	13 500/16 200/20 200	135	80+	50 000	Type V	B3-U0-G3	1.48	Black	Yes	0.90	20	1

<sup>1</sup> Typical color temperature range: +/- 5 %.

<sup>2</sup> Lumen values are derived from photometric testing. Initial lumens range: +/- 10 %.

<sup>3</sup> Lumen values are based on 4 000 K default programming. Please refer to the LUMEN SPECIFICATION TABLE for more details on other color temperatures.

<sup>4</sup> Life hours are derived from IESNA LM-80-08 testing report and projected per IESNA TM-21-11 extrapolations.

## DLC UNIQUE ID TABLE

Order code	Model Number	DLC Premium Unique ID <sup>1</sup>
69662	PTRPS755Q3CBKPR7	S-VJCL32
69663	PTRPS1505Q2CBKPR7	S-W3NPFY

<sup>1</sup> Primary Use Designation: Outdoor Pole/Arm-Mounted Area and Roadway Luminaires

## ACCESSORIES (order separately)

Order code	Type
69664	Slipfitter
69665	Square/Round pole arm



Slipfitter



Square/Round Pole arm