

MOTION SENSOR EDGELIT LED Ceiling Luminaire 3 CCT Selectable

The EDGELIT Motion Sensor LED ceiling luminaire features a slim design allowing for a modern and minimalist look. It is an ideal solution to help illuminate a space effortlessly and conveniently as the luminaire intelligently responds to both motion and light conditions.



■ Integrated PIR Motion Sensor and Photocell

Control light in a space without having to access the wall switch. The integrated PIR motion sensor and photocell will turn the luminaire ON or OFF automatically, making it easier to get around in the dark, all while benefiting from energy savings.

■ Colour Selectable

Available with 3 colour temperatures (3 000/4 000/5 000 K) to choose from, this versatile luminaire has the ability to create the perfect lighting environment for all types of applications such as kitchen pantry, closets, laundry rooms, or even a hallway.

■ Easy and Quick Installation

Designed with push-lock mechanism, the EDGELIT Motion Sensor LED ceiling luminaire offers a simple and easy installation equipped with self-lock mounting clip.

Walk in, light on!

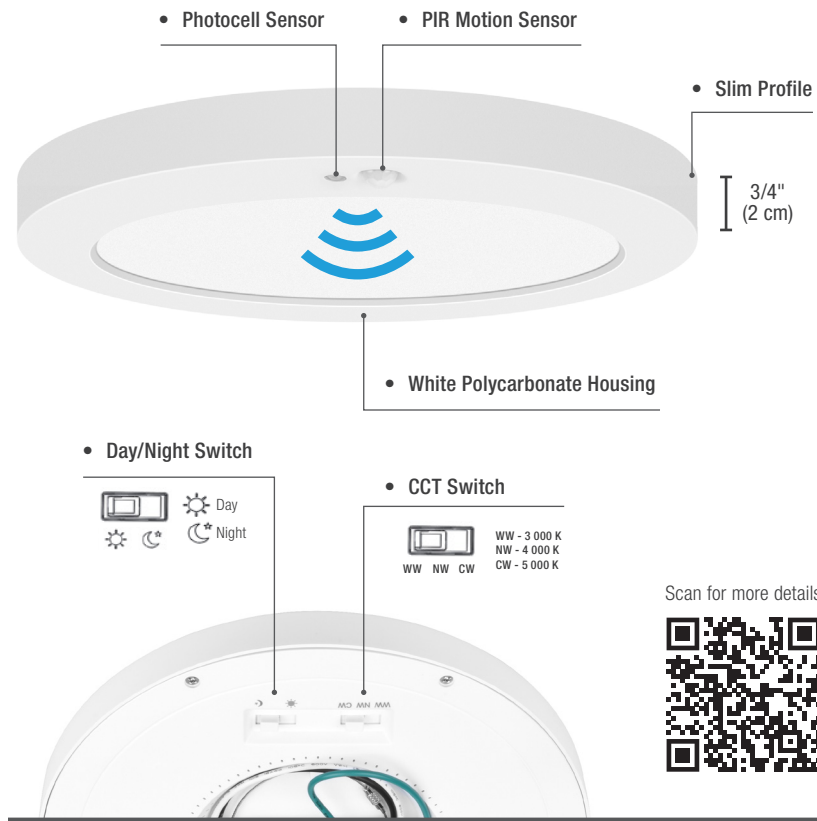

PIR Motion Sensor & Photocell

Day and Night Mode Sensor Functions

Choose day or night mode via the switch located on the back luminaire body.

Day time mode (default sensor setting)

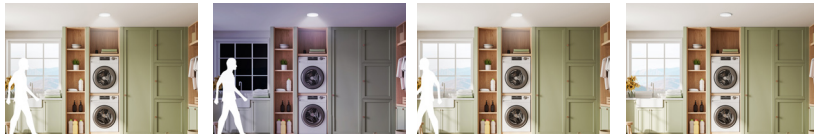

The luminaire will turn on when motion is detected, regardless of the presence of natural light.

The luminaire will remain on for 60 seconds, or until no motion is detected.

The luminaire will remain in standby mode when no motion is detected.

Night time mode

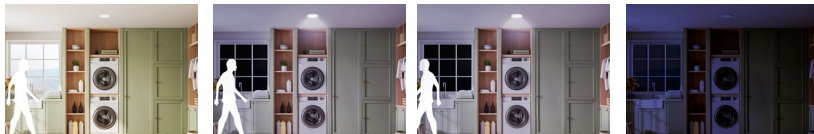

When the room is illuminated with natural light the luminaire will not turn on when someone enters the room.

When no natural light is detected, the luminaire will turn on when someone enters the room.

The luminaire will remain on for 60 seconds, or until no motion is detected.

The luminaire will remain in standby mode when no motion is detected.

Easy Installation

1. Secure mounting bracket to junction box.
2. Make wire connections.
3. Align grooves with self-lock mounting clip to the bracket and simply press into place.

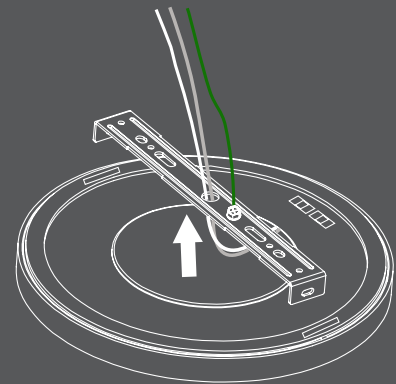
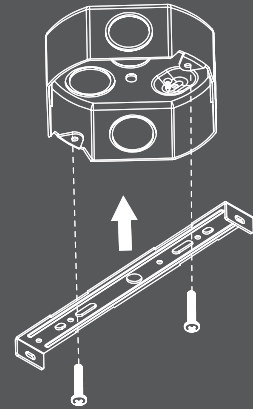

Sensor Detection Coverage

