

# PST

## LED ROUND POST TOP

### CCT AND 3 POWER SELECTABLE

### 7 PIN RECEPTACLE AND SHORTING CAP

The PST round LED post top luminaire offers a contemporary and elegant look making it a great addition to applications where energy efficiency, performance and design is essential. In 3 easy steps, the mounting arm can be interchanged with either a slipfitter or a square/round pole arm, fulfilling the need for a variety of projects. Typical applications include urban streets, walkways, parks, shopping malls, residential areas, and campuses.



## FEATURES & SPECIFICATIONS

### CONSTRUCTION

#### Physical Characteristics

- Die-cast aluminum housing comes standard in a black powder coated finish
- All configurations come standard with a 7 pin receptacle and shorting cap. 3-pin and 7-pin photocells available as accessories
- Easy access to color temperature and power select switch

#### Mounting

- The post top arm accommodates 2-3/8" and 3" tenons
- Slipfitter and Square/Round pole arm as accessories

#### Optics

- Type V distribution that provides wide uniform light output

### PERFORMANCE DATA

- Available in both 3 000/ 4 000/5 000 K color temperatures for PS75 lumen package and 4 000/5 000 K for PS100 lumen package
- 80+ CRI for true color accuracy
- Electrical ratings: 120-347 V
- Estimated life of over 50 000 hours to L70
- 0-10 V dimming standard
- Operating temperature: -40 °C to +45 °C
- 6Kv Surge Protection

### COMPLIANCES

- cULus listed for wet locations
- Meets requirements of ICES-005 issue 5 class B for use in residential applications
- IP65
- IK08
- DLC Premium
- 3G vibration resistant in compliance with ANSI/IEEE C136.31 standard for luminaire vibration

OVERVIEW			
LIGHT SOURCE	LED	EFFICIENCY (LM/W)	120 - 347
WATTS [W]	50/60/75 100/120/150	COLOR TEMPERATURE [K]	3 000/4 000/5 000 4 000/5 000
LUMEN OUTPUT [LM]	6 750 - 10 125 13 500 - 20 200	CRI	80+

<sup>1</sup> When the luminaire is set at 3 000 K operation. Only model PSTPS755323CBKPR7 must be ordered for IDA certification compliance.

Data is based upon tests performed in a controlled environment. Actual performance can vary depending on operating conditions. All products are subject to change or may be discontinued any time without notice.

## QUICK SHIP ORDERING GUIDE



PART NO	WATTS [W]	VOLTS [VAC]	COLOR TEMP. [K] <sup>1</sup>	LUMEN OUTPUT [LM] <sup>2,3</sup>	EFFICA- CY [LM/W]	CRI	LIFE L70 [HRS] <sup>4</sup>	DISTRI- BUTION TYPE	B.U.G.	EPA [FT <sup>2</sup> ]	FIN- ISH	DIM- MING [YES/ NO]	PF	THD [%]	MAS- TER CASE QTY
PSTPS755323CBKPR7	50/60/75	120-347	30/40/50K	6 750/8 100/ 10 125	135	80+	50 000	Type V	B3-U0-G3	2.31	Black	Yes	0.90	20	1
PSTPS1505322CBKPR7	100/120/150	120-347	40/50K	13 500/16 200/20 200	135	80+	50 000	Type V	B3-U0-G3	2.31	Black	Yes	0.90	20	1

<sup>1</sup> Typical color temperature range: +/- 5 %.

<sup>2</sup> Lumen values are derived from photometric testing. Initial lumens range: +/- 10 %.

<sup>3</sup> Lumen values are based on 4 000 K default programming. Please refer to the LUMEN SPECIFICATION TABLE for more details on other color temperatures.

<sup>4</sup> Life hours are derived from IESNA LM-80 testing report and projected per IESNA TM-21 extrapolations.

## DLC UNIQUE ID TABLE

PART NO	DLC PREMIUM UNIQUE ID <sup>1</sup>
PSTPS755323CBKPR7	S-R432DQ
PSTPS1505322CBKPR7	S-8C32FQ

<sup>1</sup> Primary Use Designation: Outdoor Pole/Arm-Mounted Area and Roadway Luminaires

## QUICK SHIP SPECIFICATION TABLE

PART NO	WATTS [W]	VOLTS [V]	3 000 K		4 000 K		5 000 K	
			LUMEN OUTPUT [LM]	EFFICACY [LM/W]	LUMEN OUTPUT [LM]	EFFICACY [LM/W]	LUMEN OUTPUT [LM]	EFFICACY [LM/W]
PSTPS755323CBKPR7	50/60/75	120-347	9 750	130	10 500	140	10 125	135
PSTPS1505322CBKPR7	100/120/150	120-347	N/A	N/A	21 300	142	20 700	138

## DEFAULT PROGRAMMING

PSTPS755323CBKPR7	75 W / 4 000 K
PSTPS1505322CBKPR7	150 W / 4 000 K



SLIPFITTER



SQUARE/ROUND POLE ARM

## ACCESSORIES (ORDER SEPARATELY)

PART NO	TYPE
CAS1011-SWIVEL-BK	Slipfitter
CAS1011-RNDSQBK	Square/Round pole arm
PH0033	3-Pin twist lock photocell
PH0034	7-Pin twist lock photocell



3-PIN TWIST LOCK  
PHOTOCELL



7-PIN TWIST LOCK  
PHOTOCELL

## EPA VALUES [FT<sup>2</sup>]

### LUMINAIRE WITH SLIPFITTER MOUNT

WATTS					
[W]					
75 W, 150 W	2.09	4.18	4.18	5.58	6.99

### LUMINAIRE WITH SQUARE/ROUND POLE ARM MOUNT

WATTS					
[W]					
75 W, 150 W	2.30	4.58	4.58	6.19	7.80

### Step 1: Remove the post top arm

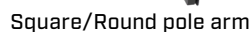
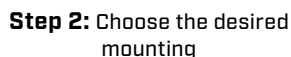

**Step 3:** Install the new luminaire onto the pole.



<sup>1</sup> Refer to the installation instruction for more details

## COMPATIBLE DIMMERS<sup>1</sup>

**Dimming range:** 0%-100%

<sup>1</sup> This table shows dimmers that have been tested and have demonstrated proper operation under normal conditions. Each installation being unique, various factors such as load, common neutrals or other electrical products on the circuit can, in certain instances, cause variance in system performance. Read and comply to the dimmer installation instructions. Consult dimming system manufacturer for additional support in operation. Some dimmers may require more than one product for stable operation. Aimilite recommends to use dimmers designed to work with LED products. Older dimmers designed for incandescent products may cause erratic operation.

## DRILLING PATTERN

**CAS1011-RNDSQBK**

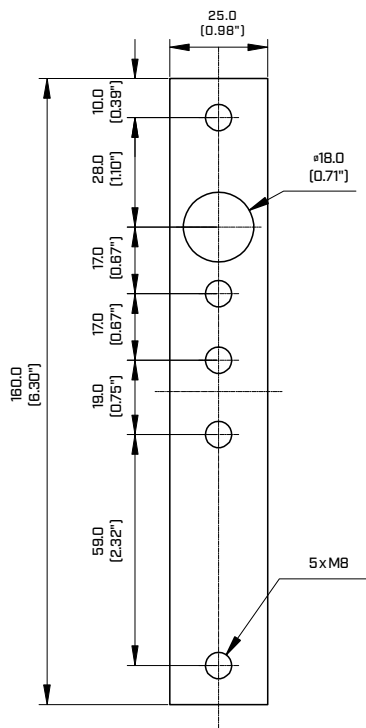

## DIMENSIONS AND WEIGHTS

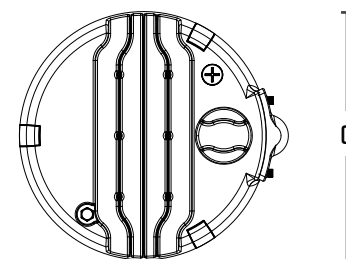

	PS75, PS150
A in. [cm]	18.31" [46.5 cm]
B in. [cm]	13.9" [35.3 cm]
C in. [cm]	12.8" [32.5 cm]
Net weight [lbs]	9.46

## PHOTOMETRIC DATA<sup>1</sup>

PSTPS755323CBKPR7 • 75 W • 4 000 K • 11 518 LM

### POLAR CANDELA DISTRIBUTION

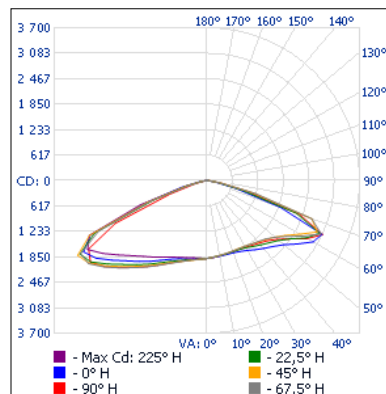

### ZONAL LUMEN SUMMARY

ZONE	LUMENS	% FIXTURE
0-30	1 658.7	14.4
0-40	3 047.8	26.5
0-60	7 616.7	66.1
60-90	3 810.1	33.1
70-100	1 060.3	9.2
90-120	35.7	0.3
0-90	11 426.9	99.2
90-180	91.6	0.8
0-180	11 518.4	100

### ILLUMINANCE AT A DISTANCE

CENTER BEAM FC		BEAM WIDTH	
17.0'	6.53	68.8'	58.1'
34.0'	1.63	137.6'	116.3'
51.0'	0.73	206.4'	174.4'
68.0'	0.41	275.2'	232.5'
85.0'	0.26	344'	290.7'
102.0'	0.18	412'	348.8'

■ Vert. Spread: 127.4° ■ Hor. Spread: 119.4°

PSTPS1505322CBKPR7 • 150 W • 4 000 K • 20 937 LM

### POLAR CANDELA DISTRIBUTION

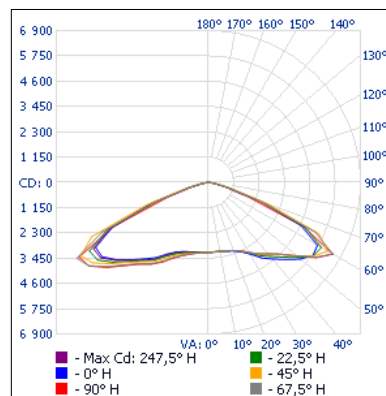

### ZONAL LUMEN SUMMARY

ZONE	LUMENS	% FIXTURE
0-30	2 899.5	13.8
0-40	5 535.6	26.4
0-60	14 770.2	70.5
60-90	6 166.4	29.5
70-100	1 398.5	6.7
90-120	0	0
0-90	20 936.6	100
90-180	0	0
0-180	20 936.6	100

### ILLUMINANCE AT A DISTANCE

CENTER BEAM FC		BEAM WIDTH	
17.0'	11.0	45.8'	66.9'
34.0'	2.76	91.7'	133.7'
51.0'	1.23	137.5'	200.6'
68.0'	0.69	183.4'	267.5'
85.0'	0.44	229.2'	334.3'
102.0'	0.31	275.1'	401.2'

■ Vert. Spread: 106.9° ■ Hor. Spread: 126.1°

<sup>1</sup> Complete IES files available on our website.