

RPTE EDGELIT UNIVERSAL MOUNTING

The RPTE series of commercial edgelit signs provides interiors with a clean, distinguished appearance. Standard universal surface mount with optional recessed backbox assembly. The RPTE series is available in AC only, AC/DC and internally self-powered versions.



FEATURES & SPECIFICATIONS

ELECTRICAL CIRCUITRY - AC & AC/DC

- LED ultra bright light source
- 120/277/347 V AC Input, field selectable
- 120 V/0.029 A/2.00 W, 277 V/0.008 A/1.60 W, or 347 V/0.011 A/1.90 W max power consumption
- Emergency DC wattages as follows:
 6 V DC = 0.88 W
 12 V DC = 0.85 W
 24 V DC = 0.78 W

ELECTRICAL SELF-POWERED

- LED ultra bright light source
- 120/277/347 V AC Input, field selectable
- 120 V/0.034 A/3.50 W, 277 V/0.012 A/2.85 W, or 347 V/0.013 A/3.50 W max power consumption
- High-performance, sealed Ni-Cad battery
- 90 minutes emergency duration [standard]
 120 minutes emergency duration is optional
- Solid state transfer and battery charger

SPECIFICATIONS



- Housing, chassis, and finish trims are made from high grade aluminum. Backbox is made of steel
- All electronics and faceplate mounted to single chassis for rapid and simple installation
- Separate backbox/housing (IC) can be pre-installed at any time prior to faceplate and electronics
- Hanger bars for drywall ceilings or walls included. Maximum extension of 540 mm
- White powder coat finish standard
- Every unit come standard with multiple running man legends
- Universal mounting for surface wall, ceiling, and pendant
- Black end caps and canopy come standard with brushed aluminum finish

APPROVALS

- CSA Certified to C22.2 #141-15
- CSA Certified to C860-11

COMPLIANCE

- Meets requirements of ICES-005

OVERVIEW	
INPUT VOLTAGE	120/277/347
INPUT VOLTAGE	UNV DC OR AC ONLY: 120 V / 0.029 A / 2.00 W, 277 V / 0.008 A / 1.60 W, 347 V / 0.011 A / 1.90 W SELF-POWERED: 120 V / 0.034 A / 3.50 W, 277 V / 0.012 A / 2.85 W, 347 V / 0.013 A / 3.50 W
DC VOLTAGE/POWER	06 V DC = 0.88 W 12 V DC = 0.85 W 24 V DC = 0.78 W
<div>  LED  ICES 005  SP[®] <small>Energy Verified Energie Vérifiée</small> </div>	

TYPICAL SPECIFICATION



TYPICAL SPECIFICATION

Supply and install Aimlite RPTE Series, The Running Man Edgelit Exit Sign shall be surface or fully recessed, operate with AC/DC field selectable 120/277/347 V AC Input, field selectable Emergency DC voltage as follows 6 V 0.9 W, 12 V 0.9 W, 24 V DC 0.9 W. The Self powered configuration shall be AC field selectable 120/277/347v and consist of a long lasting Nickel-Cadmium battery and shall stay illuminated for a minimum of 120 minutes upon AC failure. The face shall be illuminated by using Nichia LED ultra-bright light source. The sign shall be surface mount and suitable for, end, ceiling, or wall mount and come complete with 3 Running Man fibers for universal direction. The frame shall be extruded aluminum and come complete with a polycarbonate face plate for maximum uniformity. The recessed option shall consist of a rigid steel back box and come complete with field adjustable hanger bars. The Exit Running Man Sign shall be CSA 22.2 No.141-15 certified, ICES 005 compliant and be Aimlite model number RPTE_____.

ORDERING GUIDE

RPTE					
SERIES	NBR OF FACES	MOUNTING	COLOR	DC VOLTAGE*	OPTIONS
RPTE	U - UNIVERSAL 1' - SINGLE FACE ¹ 2' - DOUBLE FACE ¹	M - UNIVERSAL MOUNT P - PENDANT MOUNT	WHT - WHITE (STANDARD) BLK - BLACK BSH - BRUSHED ALUMINUM	UNVDC - UNIVERSAL DC BACKUP VOLTAGE FROM 6, 12 OR 24 V DC SELECTABLE BAT - SELF-POWERED FOR 90 MINUTES BAT1 - SELF-POWERED FOR 120 MINUTES	ATD - AUTOMATIC TEST SELF-DIAGNOSTIC SPW - SPECIAL WORDING CCWH ² - CANOPY AND ENDCAPS WHITE (ORDER SEPARATELY) ² LBN - LOW BRIGHTNESS O - NO INDICATORS (DOUBLE FACE ONLY) ↓ ↑ ↗ ↘ ↙ ↘ D U UR DR DL UL

* If AC only is required, select the UNVDC option and do not connect the DC wires when installing.

¹ Unit comes standard as universal face. Single face or double face should only be specified when choosing nonstandard fibers.

² For brushed aluminum only.

ACCESSORIES (ORDER SEPARATELY)

PART NUMBER	TYPE
CPY-CCWH-SIN	CANOPY AND ENDCAPS WHITE (FOR BRUSHED ALUMINUM ONLY)

MOUNTING

TO CONVERT FROM SURFACE MOUNT TO RECESSED MOUNT, PLEASE ORDER APPROPRIATE COLORED MOUNTING CONVERSION KIT SEPARATELY.

PART NUMBER	TYPE
UNVDC	
BBX-TE-BSH-UNVDC	RECESSED BACKBOX WITH BRUSHED ALUMINUM TRIM
BBX-TE-WHT-UNVDC	RECESSED BACKBOX WITH WHITE TRIM
BBX-TE-BLK-UNVDC	RECESSED BACKBOX WITH BLACK TRIM
BAT	
BBX-TE-BSH-BAT	RECESSED BACKBOX WITH BRUSHED ALUMINUM TRIM
BBX-TE-WHT-BAT	RECESSED BACKBOX WITH WHITE TRIM
BBX-TE-BLK-BAT	RECESSED BACKBOX WITH BLACK

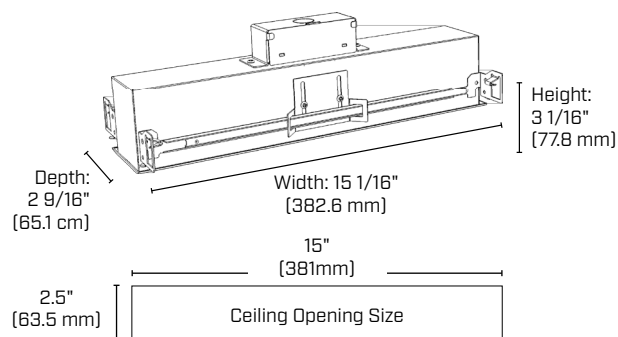

DIMENSIONS

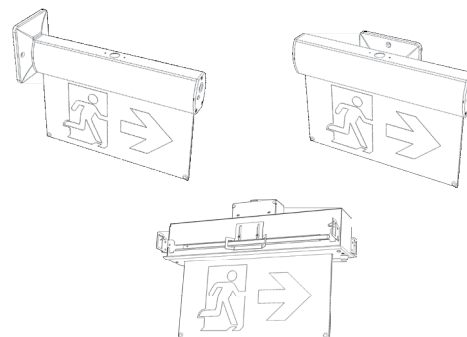
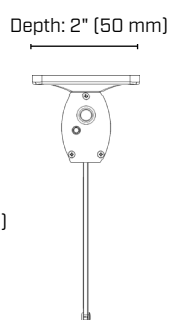
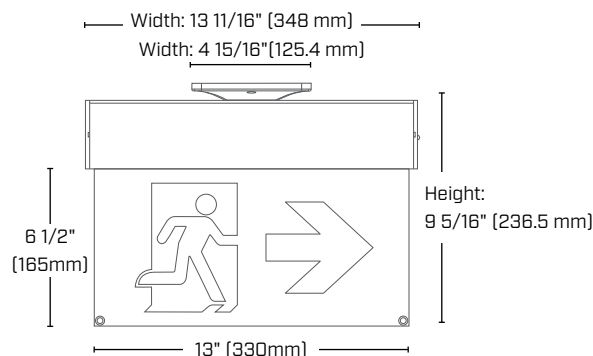

CONFIGURATIONS



Comes standard with three pictogram legends for direction selection.

Data is based upon tests performed in a controlled environment. Actual performance can vary depending on operating conditions. All products are subject to change or may be discontinued any time without notice.