

# RMMG RECESSED REMOTE

MR16 RECESSED CEILING  
 ADJUSTABLE GIMBAL  
 6 V, 12 V, & 24 V LAMPS

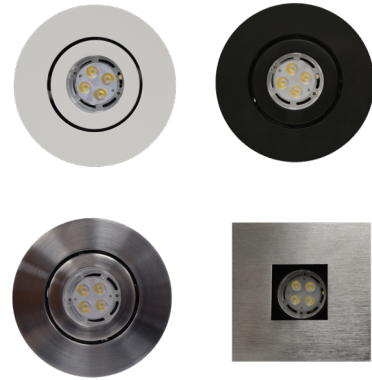
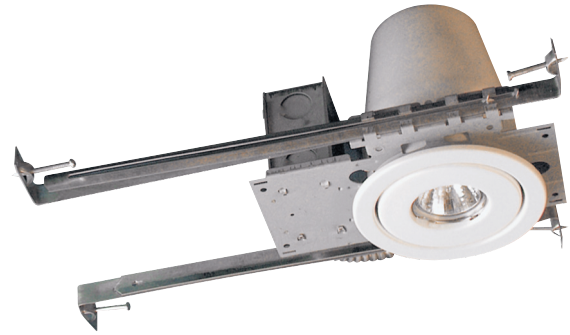

The RMMG series of commercial recessed MR16 remotes has been designed to blend seamlessly into modern decors. The backbox can be mounted in a variety of ways above suspended or drywall ceilings, leaving only the lamp and compact trim plate visible. Trimplates snap into the housing and come in a variety of colours and finishes. The RMMG is available in 6 V, 12 V, and 24 V models, all utilizing low glare, MR16 quartz halogen or LED lamps.

## FEATURES & SPECIFICATIONS



### MECHANICAL

- Steel housing/backbox and trim plate
- Backbox recesses completely above ceiling
- Backbox c/w plaster ring and adjustable T-bar or nail-in hanger bars
- Adjustable gimbal mounted lamp
- White trim paint finish is standard, other colors and finishes are optional

- MR16 lamp designed with low glare reflector and available in 6 VDC, 12 VDC or 24 VDC

### COMPLIANCES

- Compliant with CSA C22.2 #141-15
- Meets requirement of ICES-005

| OVERVIEW   |  |   |           |
|--|--|---|-----------|
| <b>LIGHT SOURCE</b>  | LED  | <b>INPUT VOLTAGE (VDC)</b>  | 6, 12, 24 |
|  NUCLEUS COMPATIBLE |  ICES 005 |  |           |

For complete warranty details, please see our terms and conditions on our website.

Data is based upon tests performed in a controlled environment. Actual performance can vary depending on operating conditions. All products are subject to change or may be discontinued any time without notice.

## ORDERING GUIDE - LED

| SERIES | NUMBER OF HEADS | VOLTS (VDC OPERATIONAL) | WATTS (W)    | LAMP TYPE | COLOR  | OPTIONS                       |
|--------|-----------------|-------------------------|--------------|-----------|--|-------------------------------|
| RMMG   | 1 - SINGLE HEAD | 06 - 24 - 6 TO 12       | 4W - 4 WATTS | LR - LED  | WH - WHITE (STANDARD)<br>BK - BLACK<br>SCH - SATIN CHROME<br>CUS - CUSTOM COLOUR (SPECIFY) | SQ - SQUARE TRIM <sup>1</sup> |
|        |                 |                         | 5W - 5 WATTS | LA - LED  |  |                               |
|        |                 | 12 - 24 - 12 TO 24      | 6W - 6 WATTS | LA - LED  |  |                               |
|        |                 |                         | 7W - 7 WATTS |           |  |                               |
|        | 1 - SINGLE HEAD | NUC - NUCLEUS DRIVER    | 5W - 5 WATTS | LA - LED  |  |                               |

<sup>1</sup> For Black square trim, contact your rep for availability

## ORDERING GUIDE - INCANDESCENT

| SERIES | VOLTS (VDC)                     | LAMP                     | COLOR  |
|--------|---------------------------------|--------------------------|--|
| RMMG   | 06V - 6<br>12V - 12<br>24V - 24 | SEE LAMP SELECTION CHART | WH - WHITE (STANDARD)<br>BK - BLACK<br>SCH - SATIN CHROME<br>CUS - CUSTOM COLOUR (SPECIFY) |

## LUMEN TABLE

| WATTS | LUMENS |
|-------|--------|
| 4W LR | 388    |
| 5W LA | 435    |
| 6W LA | 507    |
| 7W LA | 652    |

## INCANDESCENT LAMP SELECTION

| MR16 - SMALL HEAD | 6 V  | 12 V             | 24 V             |
|-------------------|------|------------------|------------------|
| QUARTZ HALOGEN    | 10WQ | 10WQ, 20WQ, 35WQ | 12WQ, 20WQ, 50WQ |

## DIMENSIONS

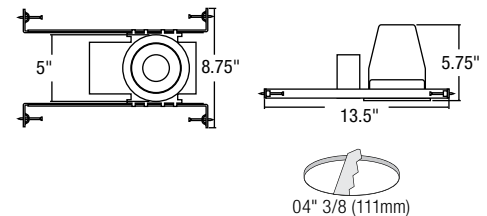

## PHOTOMETRIC DATA<sup>1</sup>

MR16-06-24V4WLR • 228.7 LM

### POLAR CANDELA DISTRIBUTION

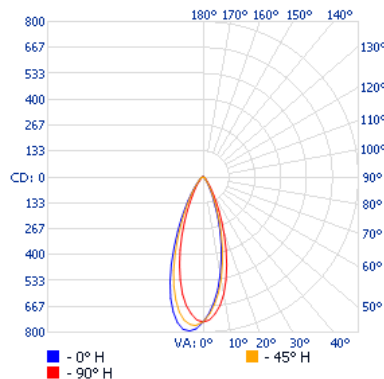

### ZONAL LUMEN SUMMARY

| ZONE   | LUMENS | % FIXTURE |
|--------|--------|-----------|
| 0-30   | 164.4  | 71.9%     |
| 0-40   | 182.0  | 79.6%     |
| 0-60   | 214.8  | 93.9%     |
| 60-90  | 13.9   | 6.1%      |
| 70-100 | 4.1    | 1.8%      |
| 90-120 | 0      | 0%        |
| 0-90   | 228.7  | 100%      |
| 90-180 | 0      | 0%        |
| 0-180  | 228.7  | 100%      |

### ILLUMINANCE AT A DISTANCE

| CENTER BEAM FC | BEAM WIDTH |
|----------------|------------|
| 1.7'           | 1.1'       |
| 3.3'           | 2.1'       |
| 5.0'           | 3.2'       |
| 6.7'           | 4.3'       |
| 8.3'           | 5.3'       |
| 10.0'          | 6.4'       |

■ Beam. Spread: 35.4°

<sup>1</sup> Complete IES files available on our website.

## PHOTOMETRIC DATA<sup>1</sup>

### MR16-06-24V5WLA • 440.7 LM

#### POLAR CANDELA DISTRIBUTION

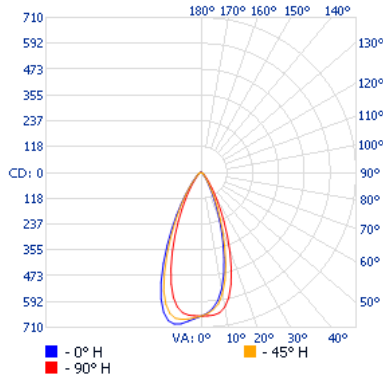

#### ZONAL LUMEN SUMMARY

| ZONE   | LUMENS | % FIXTURE |
|--------|--------|-----------|
| 0-30   | 352.6  | 80%       |
| 0-40   | 391.8  | 88.9%     |
| 0-60   | 427.2  | 96.9%     |
| 60-90  | 13.5   | 3.1%      |
| 70-100 | 4.3    | 1%        |
| 90-120 | 0      | 0%        |
| 0-90   | 440.7  | 100%      |
| 90-180 | 0      | 0%        |
| 0-180  | 440.7  | 100%      |

#### ILLUMINANCE AT A DISTANCE

| CENTER BEAM FC |      | BEAM WIDTH |      |
|----------------|------|------------|------|
| 1.7'           | 407  | 0.9'       | 1.0' |
| 3.3'           | 108  | 1.7'       | 1.9' |
| 5.0'           | 47.0 | 2.6'       | 2.8' |
| 6.7'           | 26.2 | 3.5'       | 3.8' |
| 8.3'           | 17.1 | 4.3'       | 4.7' |
| 10.0'          | 11.8 | 5.2'       | 5.7' |

■ Vert. Spread: 29.3°    ■ Hor. Spread: 31.7°

### MR16-12-24V6WLA • 508.7 LM

#### POLAR CANDELA DISTRIBUTION

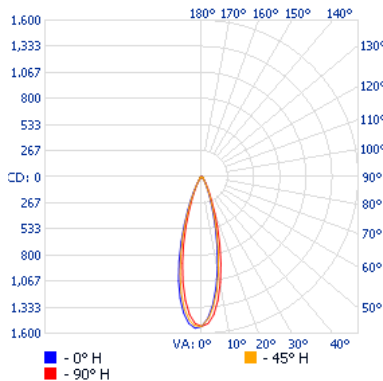

#### ZONAL LUMEN SUMMARY

| ZONE   | LUMENS | % FIXTURE |
|--------|--------|-----------|
| 0-30   | 407.0  | 80%       |
| 0-40   | 452.3  | 88.9%     |
| 0-60   | 493.1  | 96.9%     |
| 60-90  | 15.6   | 3.1%      |
| 70-100 | 4.9    | 1%        |
| 90-120 | 0      | 0%        |
| 0-90   | 508.7  | 100%      |
| 90-180 | 0      | 0%        |
| 0-180  | 508.7  | 100%      |

#### ILLUMINANCE AT A DISTANCE

| CENTER BEAM FC |      | BEAM WIDTH |      |
|----------------|------|------------|------|
| 1.7'           | 470  | 0.9'       | 1.0' |
| 3.3'           | 125  | 1.7'       | 1.9' |
| 5.0'           | 54.3 | 2.6'       | 2.8' |
| 6.7'           | 30.2 | 3.5'       | 3.8' |
| 8.3'           | 19.7 | 4.3'       | 4.7' |
| 10.0'          | 13.6 | 5.2'       | 5.7' |

■ Vert. Spread: 29.3°    ■ Hor. Spread: 31.7°

### MR16-06-24V7WLA • 635.2 LM

#### POLAR CANDELA DISTRIBUTION

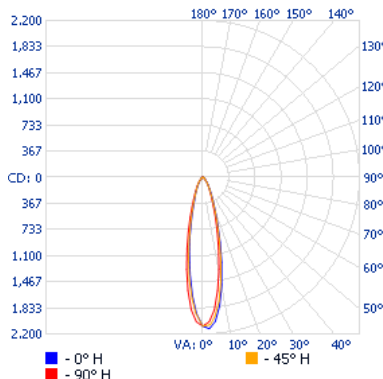

#### ZONAL LUMEN SUMMARY

| ZONE   | LUMENS | % FIXTURE |
|--------|--------|-----------|
| 0-30   | 508.2  | 80%       |
| 0-40   | 564.7  | 88.9%     |
| 0-60   | 615.7  | 96.9%     |
| 60-90  | 19.5   | 3.1%      |
| 70-100 | 6.1    | 1%        |
| 90-120 | 0      | 0%        |
| 0-90   | 635.2  | 100%      |
| 90-180 | 0      | 0%        |
| 0-180  | 635.2  | 100%      |

#### ILLUMINANCE AT A DISTANCE

| CENTER BEAM FC |      | BEAM WIDTH |      |
|----------------|------|------------|------|
| 1.7'           | 587  | 0.9'       | 1.0' |
| 3.3'           | 156  | 1.7'       | 1.9' |
| 5.0'           | 67.8 | 2.6'       | 2.8' |
| 6.7'           | 37.8 | 3.5'       | 3.8' |
| 8.3'           | 24.6 | 4.3'       | 4.7' |
| 10.0'          | 16.9 | 5.2'       | 5.7' |

■ Vert. Spread: 29.3°    ■ Hor. Spread: 31.7°

<sup>1</sup> Complete IES files available on our website.