

A city skyline at dusk with various high-rise buildings, some with lights on. A construction crane is visible in the center. A large red diagonal graphic cuts across the lower half of the image.

NUCLEUS

**SMART
EMERGENCY LIGHTING**

AimLite

AimLite

NUCLEUS

SIMPLE. SMART. RELIABLE.

Reliability is the most important feature of any emergency power source. Without it, all other features and benefits are meaningless. Fortunately, there is now an innovative and reliable solution that greatly simplifies the installation process and considerably reduces the cost of material, labor, monitoring and maintenance: the Nucleus system. In fact, normally on signs and normally off remotes must operate independently on the building's power in the event of a power failure. It thus requires two different cables just to connect the emergency fixtures.

A third wire is even needed if we want to allow communication between the units. It therefore generates important material and labor cost, especially for large and vast buildings where running thousands of feet of wire is needed. The Nucleus system is hence the perfect solution to encounter those important costs, because it only needs a single cable instead of 3. It is actually the Nucleus drivers within the units that will allow determining what will normally be off or normally on in the circuit, as well as permitting the communication between the units and the Nucleus Software.

NUCLEUS LAYOUT

Nucleus system is a compact centralized battery that has 144 W of capacity for 1 hour. An extra battery pack can be added to increase duration, if needed. It can be split across 6 channels and be related to a maximum of 120 devices. There are 7 compatible AimLite products with Nucleus system: 6 signs and 1 remote.

Since it's a centralized battery, only one point of maintenance and service is required, being again a cost effective solution.



MONITORING & MAINTENANCE

The autotest feature allows testing of your emergency system to the Firecode of Canada's requirements. All tests and changes to the system are logged. Reports are automatically sent via email for effective maintenance. If a lamp is no longer turning on, receive a fast update by email.

For example, if there is a load variation in the system, the Nucleus software will create a report accessible in the web platform and will send an error message by email to the main user. Since it is possible to identify the units by a unique name, the main user will easily know where the defective fixture is located in the building so it can be replaced.

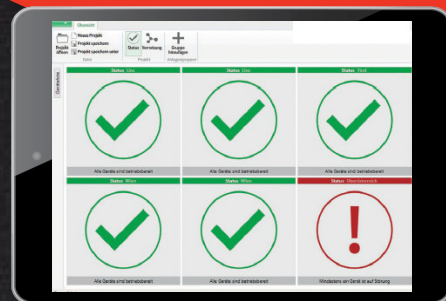

KEY FEATURES

- All-in-one solution handling Normally ON, Normally OFF, and communication with the same pair of wires
- Monitors the emergency lighting system by automatically performing the tests required by the National Building Code, reducing maintenance time and costs.
- Nucleus connects to internet via Ethernet cable and can be controlled through the app or web from anywhere in the world
- All Nucleus systems installed in multiple buildings can be controlled, operated and monitored remotely in the same group using the Nucleus Web platform
- Maintenance report is created and available on the app or web platform
- Error notifications and important information are sent to the predefined user
- Nucleus is a centralized battery, meaning only one point of maintenance is needed

The autotest feature allows testing of your emergency system to the Firecode of Canada's requirements.

CUSTOMIZATION

The Nucleus system is equipped with an automatic search and light coding function. It means the main user can identify every single unit present in a building with a unique name or code, so it is easier for maintenance afterwards and avoid laborious coding errors.

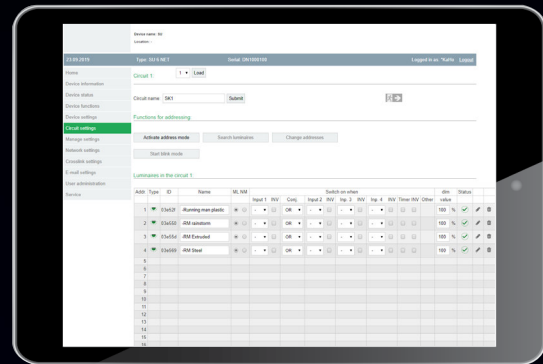

Control the Nucleus Web platform through the app or web from anywhere in the world

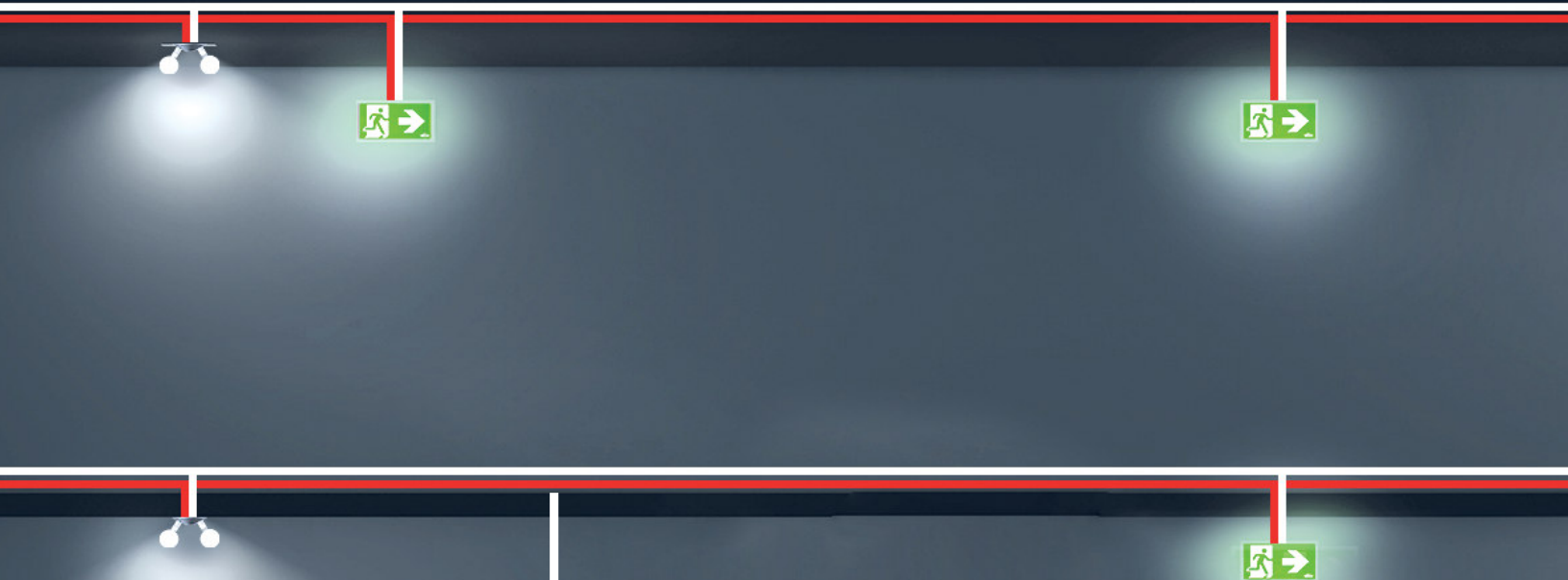

**Same pair of wires for
Normally ON signs,
Normally OFF remotes
and communication**



NETWORKING

Due to the Nucleus functionality, all systems in its group can be centrally controlled, operated and serviced. Ultimately, the full potential of the Nucleus system unfolds with its visualization software. Nucleus connects to the Internet via an Ethernet cable and can be controlled through the app. or web from anywhere in the world.

All the emergency lighting systems of multiple buildings can thus be visualized in the same network by a single person and from any location with an Internet connection. Information about the status of the systems will be sent by e-mail to the main user.

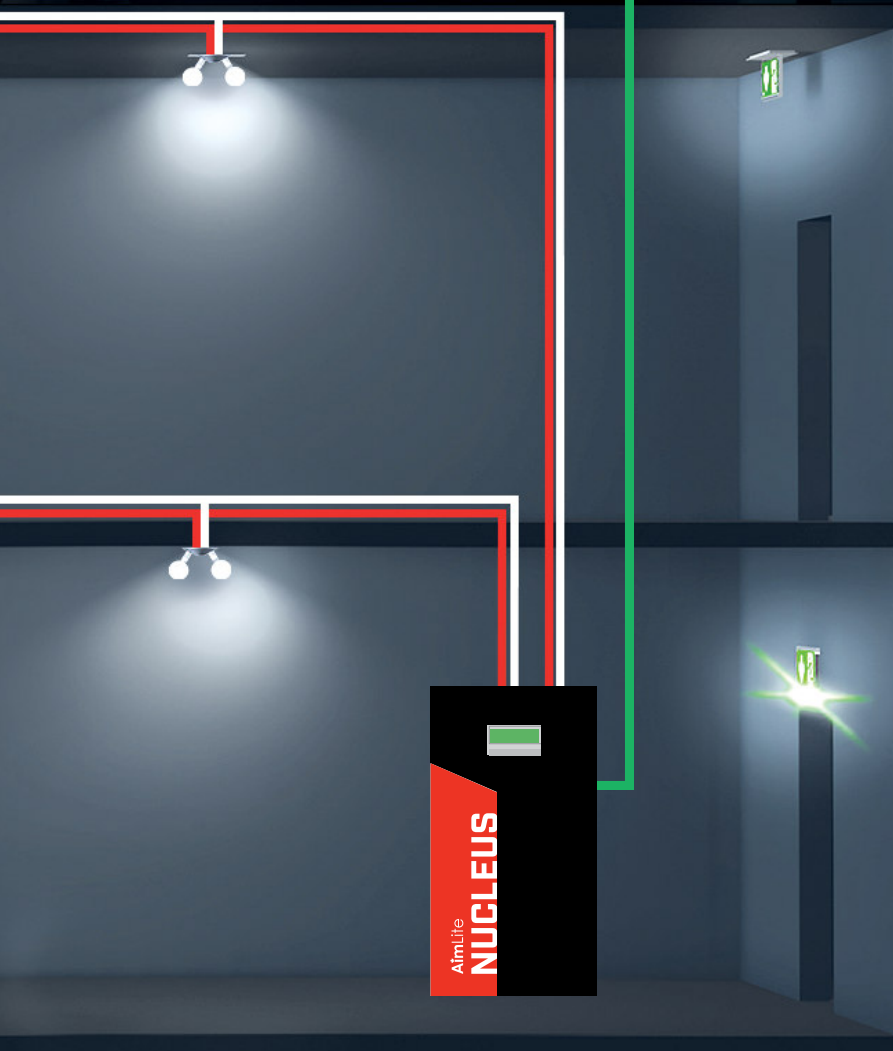

NUCLEUS

SMART EMERGENCY LIGHTING

The Nucleus system is an innovative solution to emergency lighting with its advanced features in a simple layout and cost-effective installation. This is an all-in-one solution that handles Normally ON, Normally OFF, and communication with the same pair of wires. Nucleus is connected to the internet via an Ethernet cable and can be controlled through the app or web from anywhere in the world. It is thus possible to control more than one unit within a single building, as well as manage multiple buildings remotely from a single access point. Furthermore, only one point of maintenance is needed since it is now possible to daisy-chain your Running Man signs and remote lights back to your centralized Nucleus battery unit. The auto-test feature allows testing of your emergency system to the fire code of Canada's requirements. All tests and changes to the system are logged. Reports are automatically sent via email for effective maintenance.



FEATURES AND SPECIFICATIONS

CIRCUITRY

- 120/277/347VAC input, field selectable
- 24VDC output
- 144 W maximum evenly split across 6 inputs (channels) not exceeding 54 W per input (channel)
- 2 DC terminal blocks per input (channel)
- Wattage capacity of 144 W maximum for 30 and 60 min emergency power duration standard

- Extra battery pack can be added for more duration
- Fully automatic, current limited charger
- High performance battery
- Programmable auto-test
- Ethernet port
- TFT display
- 4 operations buttons

MECHANICAL



- Steel construction
- Black powder coat finish comes standard
- 3 keyholes for wall mount
- 19 knockouts of 20mm for easy wiring
- Conduit entry knockouts

COMPATIBLE DEVICES

- Signs: RPST, RPALW, RPWP, RPDB, RPVR, RPSP, RPEL, RPN
- Remote: RMSM, RMN, RMMB, RMMD, RMQVD (single or double head), RMMG, RMMGR (single head)

APPROVALS

- Certified CSA to C22.2 #141-15

OVERVIEW			
LIGHT SOURCE	LED	MAX. CHANNELS	6
INPUT VOLTAGE [VAC]	120, 277, 347	MAX. CONNECTED DEVICES	120
WATTAGE CAPACITY [W]	144		
 			

For complete warranty details, please see our terms and conditions on our website.

Data is based upon tests performed in a controlled environment. Actual performance can vary depending on operating conditions.

All products are subject to change or may be discontinued any time without notice.

ORDERING GUIDE

PART NUMBER	VOLTS [VDC]	WATTS [W]	LIGHT SOURCE	INPUT VOLTS [VAC]	COLOR
NUCLEUS-6	24	144 [1 HOUR]	LED	120/277/347	BLACK

ADD-ON

PART NUMBER	DESCRIPTION
NUC-6-BATT	BATTERY PACK AND CABINET EXTENSION FOR NUCLEUS (ORDER SEPARATELY)

ACCESSORY

PART NUMBER	TYPE
NUC-ZONE6	NUCLEUS ZONE SENSE 6 IN 1 OUT AC GY

MODEL RATINGS¹

	60MIN	120MIN	180MIN	720MIN
NUCLEUS-6	144 W	96 W	60 W	24 W
NUCLEUS-6 + NUC-6-BATT ²	180 W	180 W	180 W	72 W

¹ Consult your representative for more details

² Power supply limited to 180W

DIMENSIONS

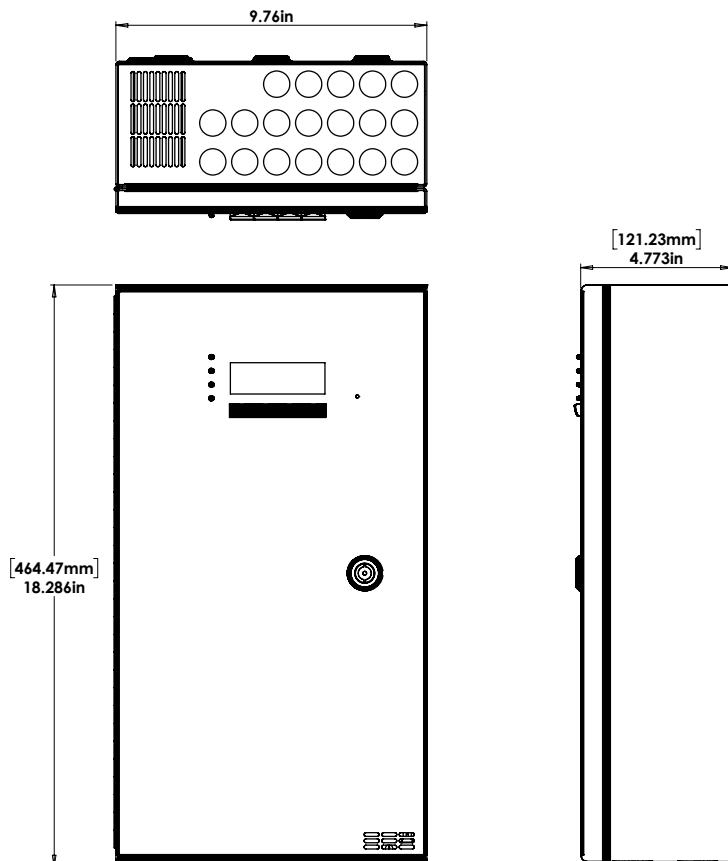



RPST

STEEL RUNNING MAN SIGN

Specification grade sign

The clean lines of the RPST series of commercial steel signs present a fully modern appearance. The high quality steel housing eliminates light leaks and provides superior illumination and uniformity. The RPST series offers a wide variety of options.



NUCLEUS
COMPATIBLE



LED



QUICKSHIP



ICES
005



Energy Verified
Energie Vérifiée

RPST		M		-		/	
SERIES	NBR OF FACES	MOUNTING	COLOR	DC VOLTAGE*	OPTIONS		
RPST	U - UNIVERSAL FACES 1 - SINGLE FACE 2 - DOUBLE FACE	M - UNIVERSAL	WHT - WHITE BLK - BLACK GRY - GREY CUS - CUSTOM COLOR (PLEASE SPECIFY)	UNVDC - UNIVERSAL DC BACKUP VOLTAGE FROM 6 TO 24 V DC BAT - SELF-POWERED FOR 90 MINUTES BAT1 - SELF-POWERED FOR 120 MINUTES NUC - NUCLEUS DRIVER	ATD ¹ , BKO, BNO, K5, PGD, SPW, VDR, WGD ² , LBN O - NO INDICATORS (DOUBLE FACE ONLY) ↓ ↑ ↗ ↘ ↙ ↘ D U UR DR DL UL Note: Indicators option available for single & double option only.		

* If AC only is required, select the UNVDC option and do not connect the DC wires when installing.

¹ ATD available with BAT and BAT1.

² Specify mounting.

RPVR VANDAL RESISTANT NBC2015 COMPLIANT

The RPVR series is designed to withstand extremely abusive environments like correctional facilities and schools. The signs are constructed from 16 gauge steel with an integral Lexan shield. Available in AC only, AC/DC and internally self-powered versions.



LED



ICES
005



NUCLEUS
COMPATIBLE



RPVR - /					
SERIES	NBR OF FACES	MOUNTING	FRAME COLOR	DC VOLTAGE*	OPTIONS
RPVR	1 - SINGLE FACE	CM - CEILING	WHT - White (standard)	UNVDC - UNIVERSAL DC BACKUP VOLTAGE 6, 12 AND 24VDC	ATD ¹ , BKO ² , BNO ² , SPW, VCC, WGO ³
	2 - DOUBLE FACE	WM - WALL MOUNT EM - END MOUNT	CUS - Custom color (please specify)	BAT - SELF-POWERED FOR 90 MINUTES BAT1 - SELF-POWERED FOR 120 MINUTES NUC - NUCLEUS DRIVER	O- NO INDICATORS (DOUBLE FACE ONLY) ↓ ↑ ↗ ↘ ↙ ↘ O U URDRDLUL Note: Indicators option available for single & double option only.

* If AC only is required, select the UNVDC option and do not connect the DC wires when installing.

¹ ATD available with BAT and BAT1.

² Available only with OP option.

³ Specify mounting.



RPEL EDGE LIT UNIVERSAL MOUNTING

The RPEL series of commercial edgelit signs provides interiors with a clean, distinguished appearance. Standard universal surface mount with optional recessed backbox assembly. The RPEL series is available in internally self-powered versions.



NUCLEUS
COMPATIBLE



LED



ICES
005



Energy Verified
Energie Vérifiée



RPEL					
SERIES	NBR OF FACES	MOUNTING	COLOR	DC VOLTAGE (VDC)	OPTIONS
RPEL	U - UNIVERSAL FACES 1 - SINGLE FACE 2 - DOUBLE FACE	M - UNIVERSAL MOUNT	BSH - BRUSHED ALUMINUM ¹	BAT - SELF-POWERED FOR 90 MINUTES ² BAT1 - SELF-POWERED FOR 120 MINUTES ² NUC - NUCLEUS DRIVER	CCWH - CANOPY AND ENDCAPS WHITE (FOR BRUSHED ALUMINUM ONLY) O - NO INDICATORS (DOUBLE FACE ONLY) ↓ ↑ ↗ ↘ ↖ ↗ D U UR DR DL UL Note: Indicators option available for single & double option only

¹ Black end caps and canopy [standard]

² BAT, & BAT1 versions not intended for installation on generators

RPWP - RAINSTORM

NBC2015 COMPLIANT

NEMA4X

The RPWP series of NEMA4X and EEMAC4X rated weatherproof signs is designed to operate in extreme environments. The fully gasketed housing is suitable for outdoor and wash-down locations. Available in AC only, AC/DC and internally self-powered versions.



LED



WET
LOCATION



ICES
005



NUCLEUS
COMPATIBLE



RPWP			GRY		-		/	
SERIES	NBR OF FACES	MOUNTING	FRAME COLOR	FACE COLOR	DC VOLTAGE*	OPTIONS		
RPWP	1 - SINGLE FACE 2 - DOUBLE FACE	C - CEILING W - WALL MOUNT E - END MOUNT P - PENDANT MOUNT	GRY - GREY	GRY - GREY [STANDARD] BLK - BLACK [INDOOR ONLY]	UNVDC - UNIVERSAL DC BACKUP VOLTAGE 6, 12 AND 24 VDC BAT - SELF-POWERED FOR 90 MINUTES BAT1 - SELF-POWERED FOR 120 MINUTES NUC - NUCLEUS DRIVER	ATD ¹ , BKO, BNO, SPW, WGO ²		
						O - NO INDICATORS (DOUBLE FACE ONLY) ↓ ↑ ↗ ↘ ↙ ↘ D U URDRDLUL		

* If AC only is required, select the UNVDC option and do not connect the DC wires when installing.

¹ ATD available with BAT and BAT1.

² Specify mounting.





RPALW EXTRUDED ALUMINIUM

The clean lines of the RPALW series of commercial extruded aluminum signs present a fully modern appearance. The extruded aluminum provides for a rigid, durable and lightweight sign. Available in AC only, AC/DC and internally self-powered versions.



NUCLEUS
COMPATIBLE



LED



ICES
005



Energy Verified
Energie Vérifiée

RPALW M - /

SERIES	NBR OF FACES	MOUNTING	COLOR	DC VOLTAGE*	OPTIONS
RPALW	1 - SINGLE FACE 2 - DOUBLE FACE U - UNIVERSAL FACE	M - UNIVERSAL	WHT - WHITE (STANDARD) BLK - BLACK GRY - GREY BSH - BRUSHED ALUMINIUM CUS - CUSTOM COLOR (PLEASE SPECIFY)	UNVDC - UNIVERSAL DC BACKUP VOLTAGE 6, 12 AND 24 VDC BAT- SELF-POWERED FOR 90 MINUTES BAT1 - SELF-POWERED FOR 120 MINUTES NUC - NUCLEUS DRIVER	ATD ¹ , BKO, BNO, K5, LXS ² , PGD ² , SPW, VDR, WGD ² , LBN 0 - NO INDICATORS (DOUBLE FACE ONLY) ↓ ↑ ↗ ↘ ↙ ↘ D U UR DR DL UL

* If AC only is required, select the UNVDC option and do not connect the DC wires when installing.

¹ ATD available with BAT and BAT1.

² Specify mounting.

RPDB THIN RUNNING MAN DIE CAST ALUMINUM

RPDB series of commercial decorative die cast aluminum exit signs are the perfect match of aesthetics and durability. The die cast construction produces an extremely rigid housing while the highly machined brushed housing lends a high-end look. The series has been designed to meet the C860 standard using energy efficient LEDs, with energy consumption as low as 1.9 W AC. Faceplates are hinged and snap into place for ease of installation.



LED



ICES
005



NUCLEUS
COMPATIBLE



Energy Verified
Energie Verifiée



RPDB

SERIES	NBR OF FACES	FRAME/ BACK PLATE COLOR	FACE COLOR	DC VOLTAGE*	OPTIONS
RPDB	1 - SINGLE FACE 2 - DOUBLE FACE	WHT - WHITE [STANDARD] BLK - BLACK BSH - BRUSHED ALUMINUM	WHT - WHITE [STANDARD] BLK - BLACK BSH - BRUSHED ALUMINUM	UNVDC - UNIVERSAL DC BACKUP VOLTAGE 6, 12 AND 24 VDC BAT - SELF-POWERED FOR 90 MINUTES BAT1 - SELF-POWERED FOR 120 MINUTES NUC - NUCLEUS DRIVER	ATD ¹ - AUTOMATIC TEST SELF-DIAGNOSTIC K5 - 1/2" KNOCKOUT FOR PENDANT MOUNT LXG - LEXAN GUARD (SEPARATE ORDER) WGD ² - WIREGUARD (SEPARATE ORDER) 0 - NO INDICATORS (DOUBLE FACE ONLY) ↓ ↑ ↗ ↘ ↙ ↘ D U URDRDL UL

* If AC only is required, select the UNVDC option and do not connect the DC wires when installing.

¹ ATD available with BAT and BAT1.

² Specify mounting.





RPSP PLASTIC RUNNING MAN

The RPSP series is suitable for property management and institutional applications, and is designed using durable and lightweight high impact thermoplastic. Available in AC only, AC & DC, and self-powered versions.



NUCLEUS
COMPATIBLE



QUICKSHIP



LED



RPSP		WHT	-	/
SERIES	NBR OF FACES ¹ AND MOUNTING	COLOR	DC OUTPUT	OPTIONS
RPSP	U - UNIVERSAL 1 - SINGLE FACE ¹ 2 - DOUBLE FACE ¹	WHT - WHITE	UNVDC - UNIVERSAL DC BACKUP VOLTAGE FROM 6 TO 24 VDC BAT - SELF-POWERED FOR 90 MINUTES BAT1 - SELF-POWERED FOR 120 MINUTES NUC - NUCLEUS DRIVER	WGD - WIREGUARD (SEPARATE ORDER) ² O - NO INDICATORS (DOUBLE FACE ONLY) ↓ ↑ ↗ ↘ ↙ ↘ D U UR DR DL UL

¹ Unit comes standard as universal face. Single face or double face should only be specified when choosing nonstandard fibers.

² Specify mounting.

DELUGE - RPN

WET LOCATION ANTI VANDAL RUNNING MAN



The RPN series of wet location anti vandal running man is designed to operate in extreme environments. The unit, designed using a polycarbonate housing, maintains its sealed interior with a continuous integral gasket. As well, LED pilot light and test switch are sealed type. Available in AC/DC and internally self-powered versions.



LED



WET
LOCATION



IP
RATING



ICES
005



IK10
IN
RE

ORDERING GUIDE

RPN				-		
SERIES	NBR OF FACES	MOUNTING	FRAME COLOUR	DC VOLTAGE (VDC)	OPTIONS	
RPN	1 - SINGLE FACE 2 - DOUBLE FACE	BLANK - UNIVERSAL	BLK - BLACK WHT - WHITE	UNVDC - UNIVERSAL DC BACKUP VOLTAGE FROM 6 TO 24 BAT - SELF-POWERED FOR 90 MINUTES BAT1 - SELF-POWERED FOR 120 MINUTES NUC - NUCLEUS DRIVER	ATD ¹ - AUTOMATIC TEST STANDARD CW ² - COLD WEATHER AT -20°C TO +40°C O - NO INDICATORS (DOUBLE FACE ONLY) ↓ ↑ ↗ ↘ ↙ ↘ D U UR DR DL UL	

¹Available only with BAT & BAT1. Mandatory with BAT & BAT1

²Available only with BAT



PLEASE REFER TO THE SPECIFICATION SHEET FOR MORE DETAILS

DELUGE - RPN 15

DELUGE - RMN WET LOCATION ANTI VANDAL REMOTE



The RMN series of wet location anti vandal remotes is designed to perform in extreme environments. The single or double lamp assemblies are completely protected from the elements within a fully gasketed polycarbonate housing.



NUCLEUS
COMPATIBLE



LED



WET
LOCATION



66 IP
RATING



ICES
005



IK10
IMPACT
RESISTANCE



SANITATION
NSF/ANSI 2

ORDERING GUIDE - LED

RMN		-				
SERIES	NBR OF HEADS	VOLTAGE [VDC]		WATTAGE [W]	LAMP TYPE	COLOR
RMN	1- SINGLE HEAD	06-24V - 6VDC TO 24VDC OPERATIONAL		4W - 4 WATTS	LR - LED	BLK - BLACK WHT - WHITE
	2- DOUBLE HEAD				LA - LED	
		12-24V - 12VDC TO 24 VDC OPERATIONAL		6W - 6 WATTS 7W - 7 WATTS	LA - LED	
	1- SINGLE HEAD				LA - LED	
	2- DOUBLE HEAD	NUC - NUCLEUS DRIVER		5W - 5 WATTS	LA - LED	
	NUC - NUCLEUS DRIVER		2.5W - 2.5 WATTS 5W - 5 WATTS			

RMSM

PAR18/MR16 MINI REMOTE

PLASTIC CONSTRUCTION

SINGLE, DOUBLE

The RMSM series of commercial thermoplastic PAR18/MR16 remotes provides the perfect balance of value and performance. The heads are fully adjustable and both tilt and swivel are lockable. The standard canopy is designed to mount directly to typical electrical junction boxes.



NUCLEUS
COMPATIBLE



LED



ICES
005



ORDERING GUIDE - LED

RMSM		-				/	
SERIES	NBR OF HEADS	VOLTS [V DC OPERATIONAL]	WATTAGE [W]	LAMP TYPE	COLOR	OPTIONS	
RMSM	1 - SINGLE HEAD	06-12 V - 6 TO 12	3W - 3	LJ - LED	WHT - WHITE [STANDARD] BLK - BLACK	LCP, VDR, WGD	
	2 - DOUBLE HEAD		4W - 4				
	3 - TRIPLE HEAD		5W - 5				
	4 - QUAD HEAD [REQUIRE 12" DIA. CANOPY]	12-24 V - 12 TO 24	6W - 6	LA - LED			
			7W - 7				
		24 V - 24	4W - 4	LR - LED			
			5W - 5	LA - LED			
	1 - SINGLE HEAD	NUC - NUCLEUS DRIVER	5W - 5	LJ - LED			
	2 - DOUBLE HEAD	NUC - NUCLEUS DRIVER	2.5W - 2.5				
5W - 5							

RMMB DECORATIVE REMOTE

MR16 SURFACE MOUNT SINGLE, DOUBLE

The RMMB series of commercial MR16 remotes provides exceptional light output in a compact, traditional design. The die cast, all metal housing is fully adjustable with a friction lock tilt and swivel that can be locked in place with a rear mounted set screw. The canopy is designed to mount directly to typical electrical junction boxes



NUCLEUS
COMPATIBLE



QUICKSHIP



ICES
005



ORDERING GUIDE - LED

RMMB			-				/	
SERIES	NBR OF HEADS	VOLTS [VDC OPERATIONAL]		WATTS [W]	LAMP TYPE	COLOR	OPTIONS	
RMMB	1 - SINGLE HEAD	06-24V - 6 TO 24		4W - 4 WATTS	LR - LED	WHT - WHITE [STANDARD] BLK - BLACK	LCP - LESS CANOPY VDR - TAMPER PROOF SCREWS WGD - WIREGUARD [ORDER SEPARATELY] PGD - LEXAN GUARD	
	2 - DOUBLE HEAD			5W - 5 WATTS	LA - LED			
	3 - TRIPLE HEAD	12-24V - 12 TO 24		6W - 6 WATTS	LA - LED			
	4 - QUAD HEAD [REQUIRE 12" DIA. CANOPY]			7W - 7 WATTS				
	1 - SINGLE HEAD			NUC - NUCLEUS DRIVER				
	2 - DOUBLE HEAD	NUC - NUCLEUS DRIVER	2.5W - 2.5 WATTS 5W - 5 WATTS					

RMMD

COMPACT REMOTE

MR16 SURFACE MOUNT
SINGLE, DOUBLE



The RMMD series of commercial MR16 remotes provides exceptional light output in a compact, traditional design. The die cast, all metal housing is fully adjustable with a friction lock tilt and swivel that can be locked in place with a rear mounted set screw. The canopy is designed to mount directly to typical electrical junction boxes



NUCLEUS
COMPATIBLE



QUICKSHIP



ICES
005



ORDERING GUIDE - LED

RMMD		-				/	
SERIES	NBR OF HEADS	VOLTS (VDC OPERATIONAL)		WATTS (W)	LAMP TYPE	COLOR	OPTIONS
RMMD	1 - SINGLE HEAD	06-24V - 6 TO 24		4W - 4 WATTS	LR - LED	WHT - WHITE (STANDARD) BLK - BLACK	LCP - LESS CANOPY¹ VDR - TAMPER PROOF SCREWS WGD - WIREGUARD (ORDER SEPARATELY) PGD - LEXAN GUARD
	2 - DOUBLE HEAD			5W - 5 WATTS	LA - LED		
	3 - TRIPLE HEAD	12-24V - 12 TO 24		6W - 6 WATTS	LA - LED		
	4 - QUAD HEAD (REQUIRE 12" DIA. CANOPY)			7W - 7 WATTS			
	1 - SINGLE HEAD	NUC - NUCLEUS DRIVER	5W - 5 WATTS	LA - LED			
	2 - DOUBLE HEAD	NUC - NUCLEUS DRIVER	2.5 - 2.5 WATTS 5W - 5 WATTS				

¹ LCP option only available with Single head

RMMG RECESSED REMOTE

MR16 RECESSED CEILING ADJUSTABLE GIMBAL

The RMMG series of commercial recessed MR16 remotes has been designed to blend seamlessly into modern decors. The backbox can be mounted in a variety of ways above suspended or drywall ceilings, leaving only the lamp and compact trim plate visible. Trimplates snap into the housing and come in a variety of colours and finishes

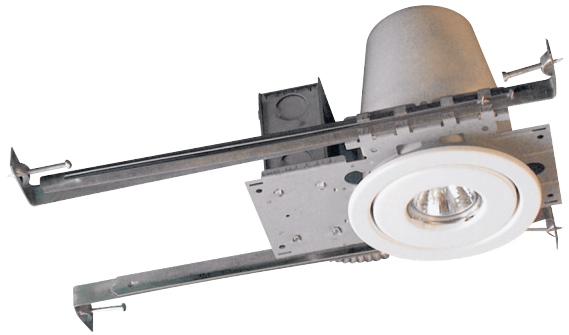

NUCLEUS
COMPATIBLE



ICES
005



ORDERING GUIDE - LED

RMMG — 1 /						
SERIES	NUMBER OF HEADS	VOLTS (VDC OPERATIONAL)	WATTS (W)	LAMP TYPE	COLOR	OPTIONS
RMMG	1 - SINGLE HEAD	06 - 24 - 6 TO 12	4W - 4 WATTS	LR - LED	WH - WHITE (STANDARD) BK - BLACK SCH - SATIN CHROME CUS - CUSTOM COLOUR (SPECIFY)	SQ - SQUARE TRIM ¹
			5W - 5 WATTS	LA - LED		
		12 - 24 - 12 TO 24	6W - 6 WATTS	LA - LED		
			7W - 7 WATTS			
	1 - SINGLE HEAD	NUC - NUCLEUS DRIVER	5W - 5 WATTS	LA - LED		

¹ For Black square trim, contact your rep for availability

RMMGR

RECESSED REMOTE

MR16 RECESSED CEILING
ADJUSTABLE GIMBAL

The RMMGR series of commercial remodeler MR16 remotes has been designed to blend seamlessly into modern decors. The backbox can be mounted in a variety of ways above suspended or drywall ceilings, leaving only the lamp and compact trim plate visible. Trimplates snap into the housing and come in a variety of colours and finishes



NUCLEUS
COMPATIBLE



ICES
005



ORDERING GUIDE - LED

RMMGR	1							
SERIES	NUMBER OF HEADS	VOLTS [VDC]		WATTS [W]		LAMP TYPE	CASTING COLOR	OPTIONS
RMMGR REMODELER	1 - SINGLE HEAD	06 - 24V	6 TO 24 OPERATIONAL	4W -	4 WATTS	LR - LED	WHT - WHITE (STANDARD)	SQR - SQUARE TRIM¹
				5W -	5 WATTS	LA - LED	BLK - BLACK SCH - SATIN CHROME CUS - CUSTOM COLOUR (SPECIFY)	
		12 - 24V	12 TO 24 OPERATIONAL	6W - 7W -	6 WATTS 7 WATTS	LA - LED		
	1 - SINGLE HEAD	NUC -	NUCLEUS DRIVER	5W -	5 WATTS	LA - LED		

¹ For Black square trim, contact your rep for availability

RMQVD

VANDAL REMOTE

DOUBLE LEXAN CUBE

The RMQVD series of vandal resistant remotes provides reliable emergency lighting in applications typically prone to abuse and tampering. The lamp assemblies are completely shielded within a pair of heavy-duty, single piece, molded Lexan cubes. Each cube can house a single or double assembly. The durable, all steel cabinet utilizes a wrap-around cover plate for added protection and strength



ORDERING GUIDE - LED

RMQVD						
SERIES	NUMBER OF LAMPS	VOLTS [VAC]	WATTS [W]	LAMP TYPE	COLOR	OPTIONS
RMQVD	1- 1 LAMP PER HEAD [2 LAMPS]	06 - 24 6 TO 12	4 W - 4 WATTS	LR - LED	WHT - WHITE [STANDARD] BLK - BLACK	VDR, WGD
	2 - 2 LAMPS PER HEAD [4 LAMPS]		5 W - 5 WATTS	LA - LED		
		12 - 24 12 TO 24	6 W - 6 WATTS 7 W - 7 WATTS	LA - LED		
	1- 1 LAMP PER HEAD [2 LAMPS]		NUC - NUCLEUS DRIVER	5 W - 5 WATTS	LA - LED	
	2 - 2 LAMPS PER HEAD [4 LAMPS]	NUC - NUCLEUS DRIVER	2.5 W 2.5 WATTS 5 W - 5 WATTS			



NOTES

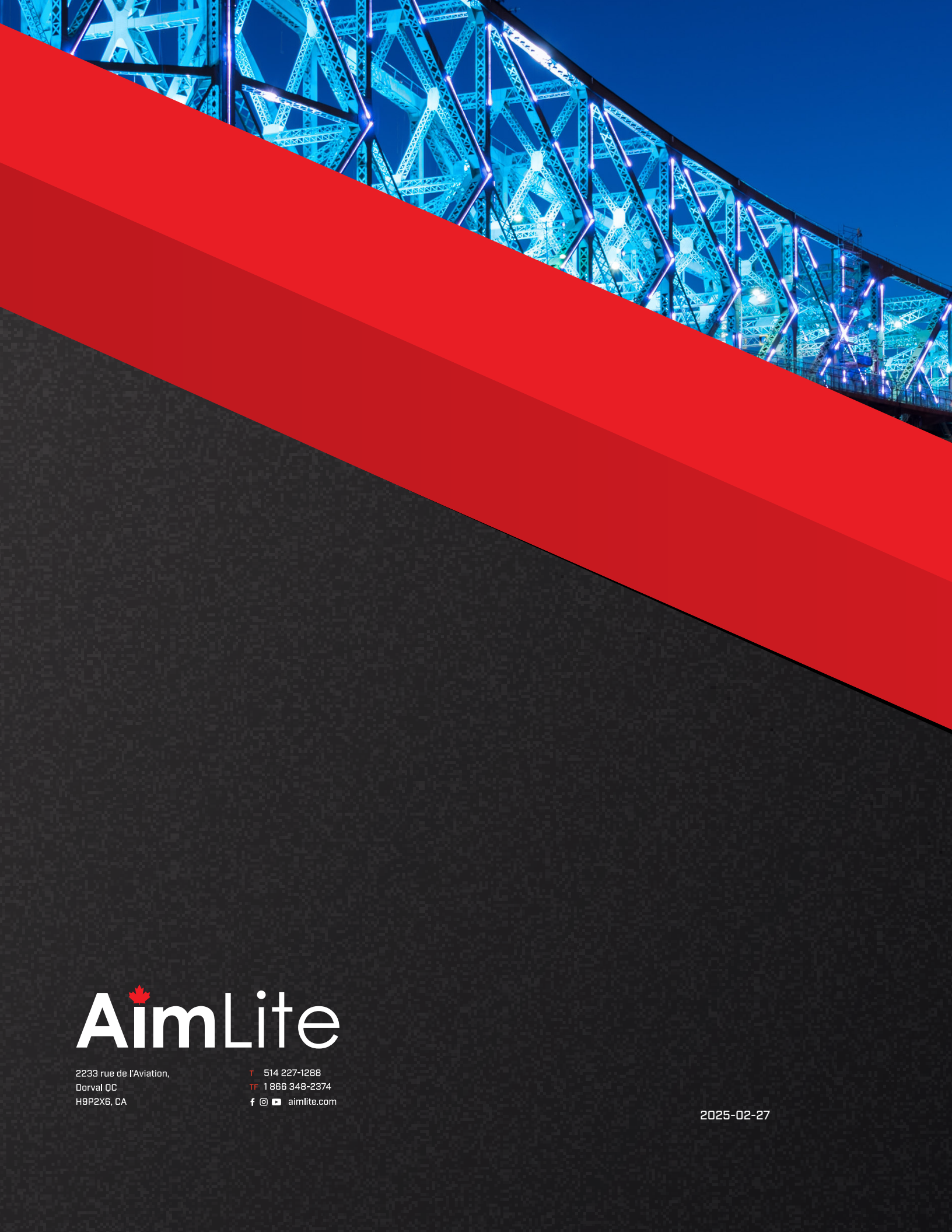

AimLite

2233 rue de l'Aviation,
Dorval QC
H9P2X6, CA

T 514 227-1288
TF 1 866 348-2374
f @ aimlite.com

2025-02-27