

Series Spec Sheet

DISK LIGHT - CLDK

LED CEILING LUMINAIRE

5 CCT Selectable

The LED Disk CLDK combines exceptional light output with a traditional ceiling look. Installing them directly into a junction box, this fixture is versatile and will fit any application. Offered in 2 sizes and 5 color temperature selectable, this ceiling luminaire is the perfect solution for commercial and residential applications.

FEATURES AND SPECIFICATIONS

• Construction

Physical Characteristics

- Perfect for restricted spaces, low ceilings and on concrete material
- Metal housing
- Frosted lens
- CCT Select switch is placed behind the housing

Mounting

- Surface mounted
- Easy keyhole installation, twist-lock lens

• Performance data

- Available in 2 700/3 000/3 500/4 000/5 000 K selectable color temperature
- 90+ CRI for true color accuracy
- Electrical ratings: 120 V
- Estimated life of over 50 000 hours to L70
- Phase cut (ELV / Triac) dimming standard
- Operating temperature:
-20 °C to 45 °C (-4 °F to 113 °F)

• Compliances

- cULus listed for wet locations
- Energy Star
- Meets requirements of ICES-005 issue 5 class B for use in residential applications

OVERVIEW

Light source	LED
Watts (W)	8, 15
Lumen output (lm)	636 - 1 299
Efficacy (lm/W)	80 - 87
Color temperature (K)	2 700/3 000/3 500/4 000/5 000
CRI	90



QUICK SHIP AND TECHNICAL SPECIFICATION TABLE ⌚

Order code	Model number	Watts (W)	Volts (V AC)	Color temp. (K) ¹	Lumen output (lm) ²	Efficacy (lm/W)	CRI	Life L70 (hrs) ³	Beam angle (°)	Finish	Dimming (Yes/No)	Power factor	THD (%)	Master case qty
5 CCT Selectable														
4"														
70176	CLDK4-G2-R8W-A/5CWH	8	120	2 700/3 000/3 500/4 000/5 000	660	83	90	50 000	113	White	Yes	≥0.90	13	16
6"														
70177	CLDK6-G2-R15W-A/5CWH	15	120	2 700/3 000/3 500/4 000/5 000	1 230	82	90	50 000	113	White	Yes	≥0.90	6.5	8

¹ Typical color temperature range: +/- 5 %.

² Lumen values are derived from Energy Star reported data. Initial lumens range: +/- 10 %.

³ Life hours are derived from IESNA LM-80 testing report and projected per IESNA TM-21 extrapolations.

LUMEN SPECIFICATION TABLE

Order code	Model number	Watts (W)	2 700 K		3 000 K		3 500 K		4 000 K		5 000 K	
			Lumen output (lm)	Efficacy (lm/W)	Lumen output (lm)	Efficacy (lm/W)	Lumen output (lm)	Efficacy (lm/W)	Lumen output (lm)	Efficacy (lm/W)	Lumen output (lm)	Efficacy (lm/W)
70176	CLDK4-G2-R8W-A/5CWH	8	636	80	668	84	702	88	713	89	706	88
70177	CLDK6-G2-R15W-A/5CWH	15	1 207	80	1 263	84	1 297	86	1 299	87	1 243	83

DEFAULT PROGRAMMING

3 000 K

COMPATIBLE DIMMERS¹

	4"	6"
Brand	Model	
Legrand	PD-5NE	PD-5NE, RH703PTUTC
Cooper	RRD-6NA, AAL06, SLC03P	RRD-6NA
Leviton	IPL06, 6674, DSL06-1ZL, DSM10-1LZ, IPE04-1LZ, DDMX1	IPL06, 6674, DSL06-1ZL, DSM10-1LZ, IPE04-1LZ, DDMX1
Lutron	PD-6WCL, DVCL-153P, CTCL-153P, DVCL-253P, AYCL-253P, DVRL-253, SELV-300P, MACL-153P	PD-6WCL, DVCL-153P, CTCL-153P, DVCL-253P, AYCL-253P, DVRL-253, SELV-300P, MACL-153P

Dimming range: 10%-100%

¹ This table shows dimmers that have been tested and have demonstrated proper operation under normal conditions. Each installation being unique, various factors such as load, common neutrals or other electrical products on the circuit can, in certain instances, cause variance in system performance. Read and comply to the dimmer installation instructions. Consult dimming system manufacturer for additional support in operation. Some dimmers may require more than one product for stable operation. Stanpro recommends to use dimmers designed to work with LED products. Older dimmers designed for incandescent products may cause erratic operation.

Data is based upon tests performed in a controlled environment. Actual performance can vary depending on operating conditions. All products are subject to change or may be discontinued any time without notice. Please contact your Stanpro customer service representative to confirm inventory levels at time of order.

DIMENSIONS AND WEIGHTS

4"

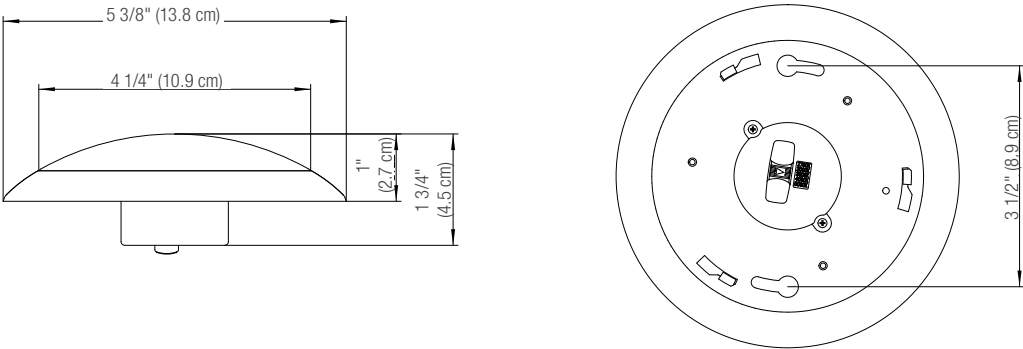

6"

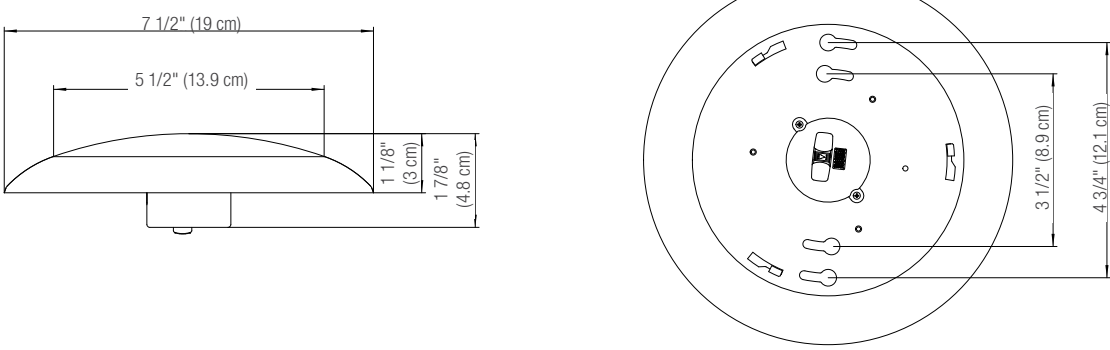

	4"	6"
Net weight (lbs)	0.45	0.62

Data is based upon tests performed in a controlled environment. Actual performance can vary depending on operating conditions. All products are subject to change or may be discontinued any time without notice. Please contact your Stanpro customer service representative to confirm inventory levels at time of order.

PHOTOMETRIC DATA¹

70176 • CLDK4-G2-R8W-A/5CWH • 3 000 K • 668.4 lm

Polar candela distribution

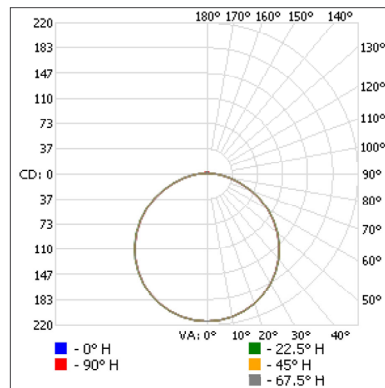

Zonal lumen summary

Zone	Lumens	% Fixture
0-30	167.8	25.1
0-40	276.5	41.4
0-60	496.6	74.3
60-90	158.8	23.8
70-100	80.9	12.1
90-120	7.6	1.1
0-90	655.4	98
90-180	13.0	2
0-180	668.4	100

Illuminance at a distance

Center beam fc		Beam width	
1.7'	74.1	5.5'	5.5'
3.3'	19.7	10.7'	10.6'
5.0'	8.56	16.2'	16.1'
6.7'	4.77	21.8'	21.6'
8.3'	3.11	26.9'	26.8'
10.0'	2.14	32.5'	32.3'

■ Vert. spread: 116.7°
■ Horiz. spread: 116.4°

70177 • CLDK6-G2-R15W-A/5CWH • 3 000 K • 1 263.2 lm

Polar candela distribution

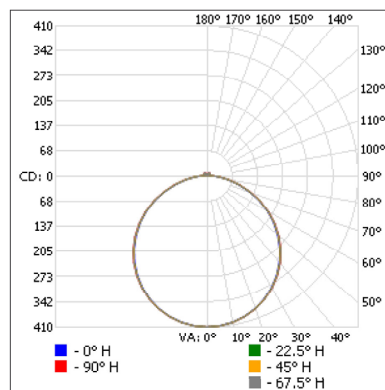

Zonal lumen summary

Zone	Lumens	% Fixture
0-30	319.8	25.3
0-40	526.2	41.7
0-60	941.6	74.5
60-90	288.4	22.8
70-100	139.7	11.1
90-120	11.9	0.9
0-90	1 230.0	97.4
90-180	33.2	2.6
0-180	1 263.2	100

Illuminance at a distance

Center beam fc		Beam width	
1.7'	142	5.3'	5.5'
3.3'	37.6	10.3'	10.6'
5.0'	16.4	15.6'	16.1'
6.7'	9.11	20.9'	21.6'
8.3'	5.94	26.0'	26.7'
10.0'	4.09	31.3'	32.2'

■ Vert. spread: 114.8°
■ Horiz. spread: 116.3°

¹ Complete IES files available on our website.

Data is based upon tests performed in a controlled environment. Actual performance can vary depending on operating conditions. All products are subject to change or may be discontinued any time without notice. Please contact your Stanpro customer service representative to confirm inventory levels at time of order.