

## PFL LED FLOOD LIGHTS

Our complete line of Flood Lights is highly versatile and well suited for the most robust construction sites. Our battery powered Flood Lights can be easily carried from one location to another and their cordless feature keeps the ground free of cables, creating a safer working environment. They are ideal for jobsites where electricity has yet to be installed, commercial projects or smaller residential tasks. Our AC Flood Light is the perfect combination of durability and efficiency. It offers a high light output and is designed for wet locations, with an IP rating of 65.

### FEATURES AND SPECIFICATIONS

#### • 20 W LED Battery Powered Flood Light

- Housing: Yellow Aluminum
- Pre-set intensities
- Battery powered
- USB outlet with smartphone charging capability
- IK10 rated
- Suitable for dry locations

**Ambient temperature**  
 -10 °C to +40 °C

#### • 50 W LED Battery Powered Flood Light

- Housing: Yellow Aluminum
- Pre-set intensities
- IK10 rated
- Suitable for dry locations

**Ambient temperature**  
 -10 °C to +40 °C

#### • 30 W AC LED Flood Light

- Housing: Yellow Aluminum
- 5' 18 AWG power cord
- IP65 rated
- Suitable for wet locations

**Ambient temperature**  
 -20 °C to +50 °C

### OVERVIEW

	LED Battery Powered Flood Light	AC LED Flood Light
Light source	LED	LED
Watts (W)	20, 50	30
Lumen output (lm)	1 100, 3 250	3 200
Efficiency (lm/W)	55, 65	107
Color temperature (K)	Cool White	Cool White
CRI	70	70
Weight (lbs)	20 W: 4.85, 50 W: 9.26	30 W: 4



20 W LED Battery Powered Flood Light



50 W LED Battery Powered Flood Light



30 W AC Flood Light

**3**  
years  
warranty

**quick  
ship**

**LED  
fixture**

**dimmable  
fixture**

**ICES  
005**

## QUICK SHIP AND TECHNICAL SPECIFICATION TABLE

Order code	Part number	Watts	Volts	Color temp.	Lumen output	Efficiency	CRI	Beam angle	Amperage	Dimming <sup>2</sup>	Lithium-ion battery			Battery working time				Battery charging time	Case qty	
		(W)	(VAC)	(K)	(lm) <sup>1</sup>	(lm/W)		(°)	(A)	(Yes/No)		(V)	(Ah)	100% brightness	50% brightness	20% brightness	Energy saving mode	(hrs)	(hrs)	(master)
		LED Battery Powered Flood Light																		
67021	PFL/BTRY/100-240/20W/CW/YL/STD	20	100-240	Cool White	1 100	55	70	129	4.4	Yes	7.4	4.4	3	6	12	N/A	5	8		
67022	PFL/BTRY/100-240/50W/CW/YL/STD	50	100-240	Cool White	3 250	65	70	120	6.5	Yes	18.5	6.6	3	6	12	N/A	6	2		

Order code	Part number	Watts	Volts	Color temp.	Lumen output	Efficiency	Wire	CRI	Life L70	Beam angle	Amperage	Dimming	Case qty
		(W)	(VAC)	(K)	(lm) <sup>1</sup>	(lm/W)			(hrs)	(°)	(A)	(Yes/No)	(master)
AC LED Flood Light													
67336	PFL/AC/30W/CW/ND/YL/STD	30	120	Cool White	3 200	107	18 AWG	70	25 000	120	0.27	No	8

<sup>1</sup> Lumen values are derived from photometric testing. Initial lumens range: +/- 10 %.

<sup>2</sup> Pre-set intensities.

## ACCESSORIES (order separately)

Order code	Part number	Watts	Lithium-ion battery		Battery working time			Battery charging time (hrs)	Compatible with	Case qty (master)
		(W)			(hrs)					
		(V)	(Ah)	100% brightness	50% brightness	20% brightness				
20 W Replacement Battery										
67024 <sup>1</sup>	PFL/REPLBTRY/7.4V/20W/YL/STD	20	7.4	4.4	3	6	12	5	67021	8

<sup>1</sup> Only the 20 W Flood Light (#67021) has a battery that can be removed and replaced. The 50 W Flood Light (#67022) has an integrated battery.

Order code	Part number	Type	Watts	Volts	Compatible with	Case qty (master)
			(W)	(VAC)		
Replacement AC/DC Charger for Battery Powered Flood Lights						
67026	PFL/CHARGER/20W/STD	12 V 1 A American Standard Charger	20	100-240	67021	25
67027	PFL/CHARGER/50W/STD	24 V 2 A American Standard Charger	50	100-240	67022	25



20 W Replacement Battery



Replacement AC/DC Charger for Battery Powered Flood Light

Data is based upon tests performed in a controlled environment. Actual performance can vary depending on operating conditions. All products are subject to change or may be discontinued any time without notice.

## DIMENSIONS

67021 20 W LED Battery Powered Flood Light

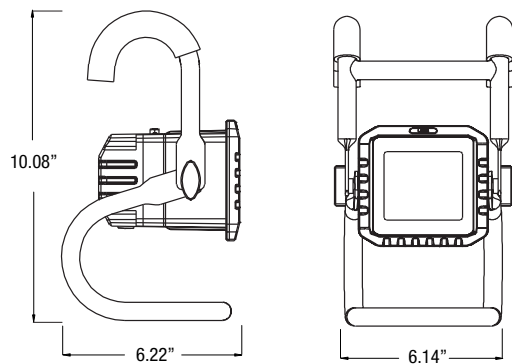

67022 50 W LED Battery Powered Flood Light

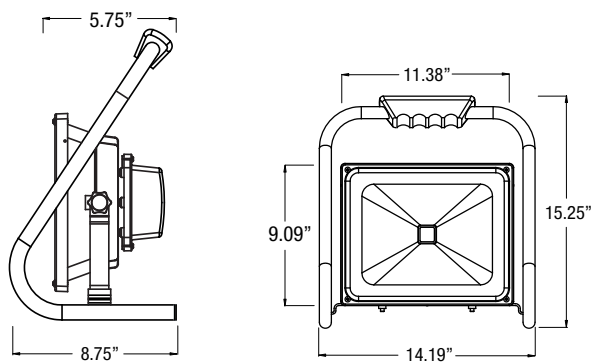

67336 30 W AC Flood Light

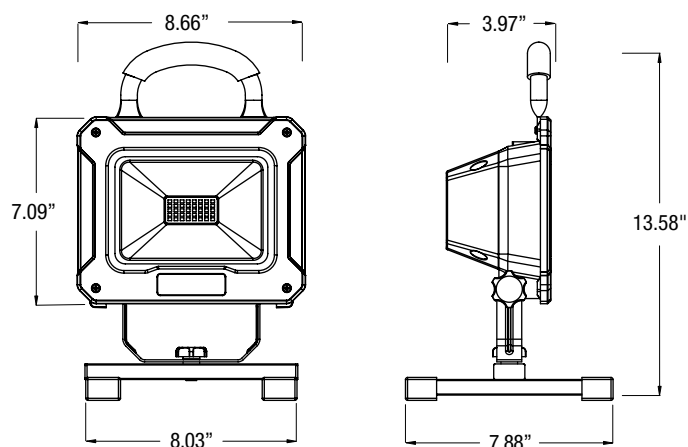

Data is based upon tests performed in a controlled environment. Actual performance can vary depending on operating conditions. All products are subject to change or may be discontinued any time without notice.

PHOTOMETRIC DATA¹

67336 • PFL/AC/30W/CW/ND/YL/STD • 3 508.0 lm

Polar candela distribution

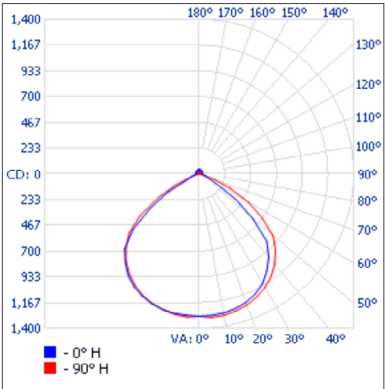

Zonal lumen summary

Zone	Lumens	% Fixture
0-30	1 040.7	29.7
0-40	1 734.9	49.5
0-60	3 019.7	86.1
60-90	321.3	9.2
70-100	101.2	2.9
90-120	70.8	2
0-90	3 341.0	95.2
90-180	166.9	4.8
0-180	3 508.0	100

Illuminance at a distance

Center beam fc		Beam width	
17.0'	4.46	42.9'	49.6'
34.0'	1.12	85.9'	99.2'
51.0'	0.50	128.8'	148.8'
68.0'	0.28	171.7'	198.4'
85.0'	0.18	214.6'	248.0'
102.0'	0.12	257.6'	297.6'

Vert. spread: 103.2°  
Horiz. spread: 111.1°

¹ Complete IES files available on our website.

Data is based upon tests performed in a controlled environment. Actual performance can vary depending on operating conditions. All products are subject to change or may be discontinued any time without notice.